

PEARSON™ CURRENT MONITOR MODEL 4997

Sensitivity	0.01 Volt/Ampere ±1%
Output resistance	50 Ohms
Maximum peak current	20,000 Amperes
Maximum rms current	150 Amperes
Drop rate	0.3 %/millisecond
Useable rise time	25 nanoseconds
Current time product	1.0 Ampere-second maximum*
Low frequency 3dB cut-off	0.5 Hz (approximate)
High frequency 3dB cut-off	20 MHz (approximate)
I/f figure	3.5 peak Amperes/Hz
Output connector	BNC (UG-290A/U)
Operating temperature	0 to 65 °C
Weight	22 ounces

* Maximum current-time product can be obtained by using core-reset bias as described in the *Application Notes*.
0.4 Ampere-second is typical without bias.

© 1999 Pearson Electronics, Inc. 4997.SPX-990513

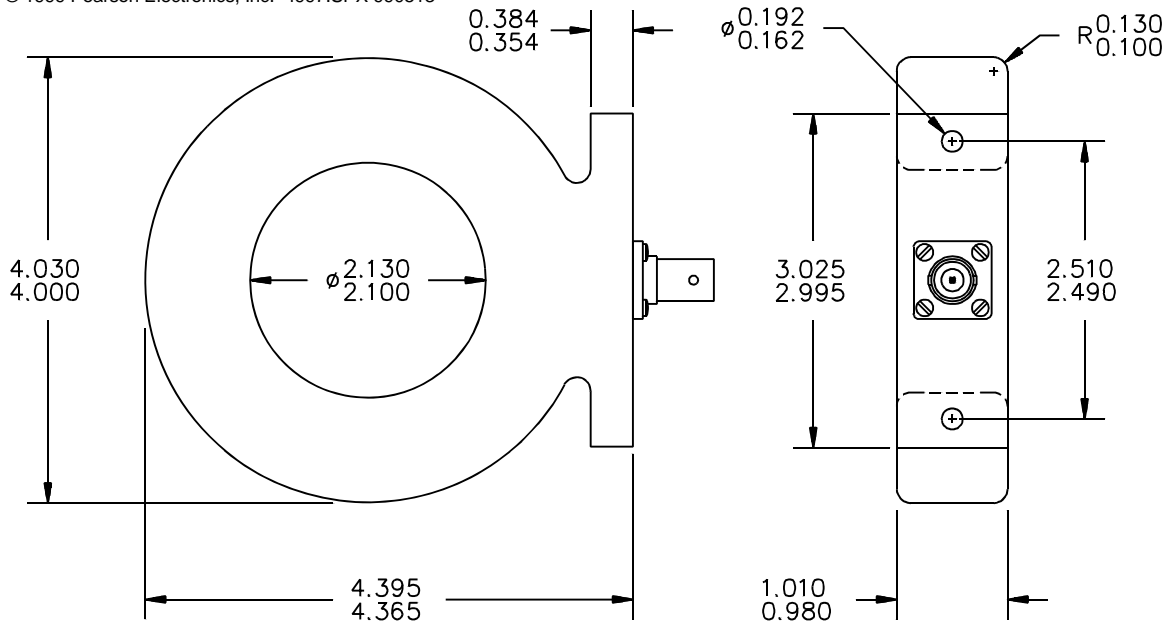

Pearson Electronics, Inc. • 4009 Transport Street • Palo Alto, CA 94303
Telephone 650-494-6444 • FAX 650-494-6716 • www.pearsonelectronics.com

擎罌實業有限公司 23552 台北縣中和市中正路716號3樓之4 (遠東世紀廣場 L棟)
Tope Co., Ltd. Tel: (02) 8228-0658 * Fax: (02) 8228-0659 * e-mail: tope@ms1.hinet.net * <http://www.sensor.tw>